

WARNING: BEFORE USAGE, THE INSTRUCTION MUSE BE READ.

THANK YOU FOR PURCHASING. THE FOLLOWING ATTENTION POINTS AND INSTRUCTIONS MUST BE READ. SHOOTING WITHOUT CAUTION OR USED IMPROPERLY, BLINDNESS OR INJURIES COULD BE LEAD.

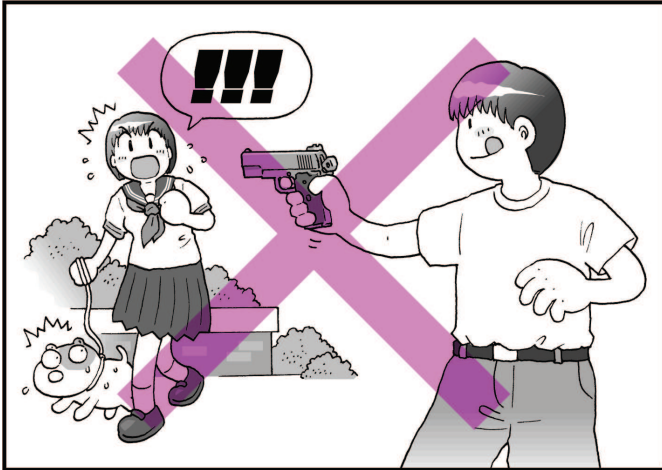

DO NOT POINT AT PEOPLE OR ANIMAL.



GUN AND GAS MUST NOT BE PLACED IN AREA WHERE TEMPERATURE IS OVER 40 °C

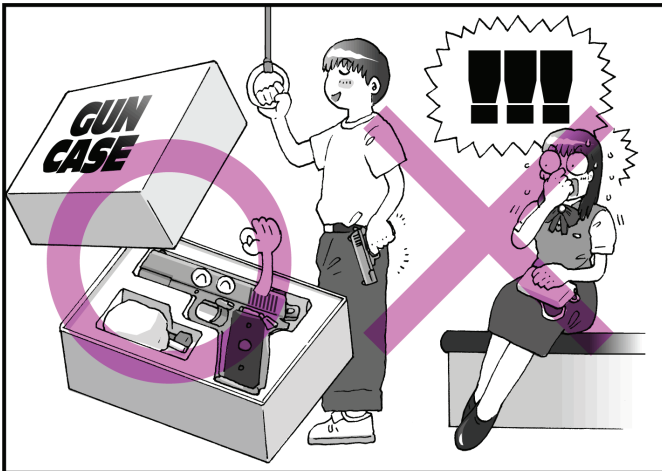

PLACE IN GUN CASE WHEN NOT IN USING OR TRANSPORTING



DO NOT USE GAS WHICH PRESSURE IS OVER 12 Kgs/cm²

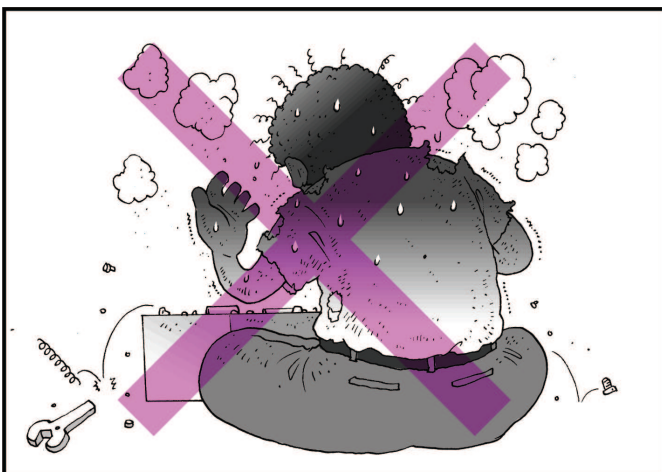

UNAUTHORIZED RECONSTRUCTION OF AIR SOFT GUN TO STRENGTHEN FIRING FUNCTION IS STRICTLY PROHIBITED.

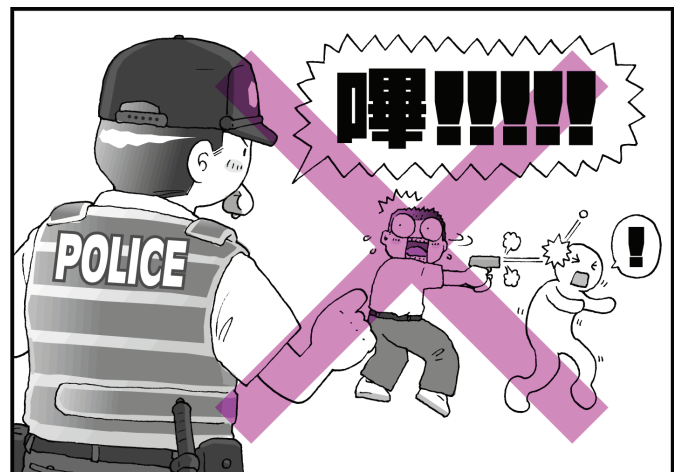

BE CAREFULL WHAT TARGET YOU SHOOT



EYE PROTECTION DEVICE MUST BE EQUIPPED

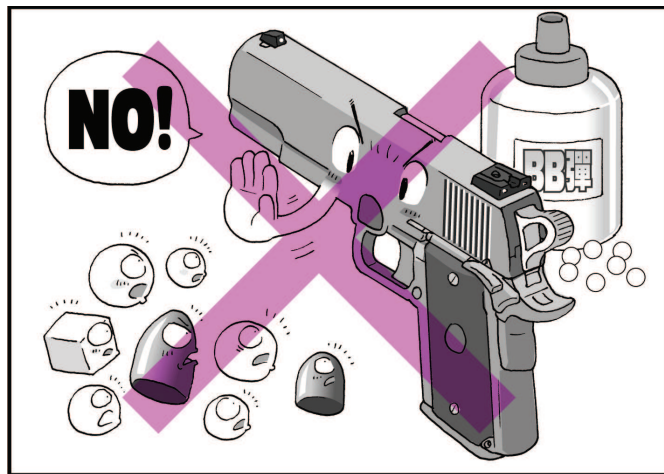

DO NOT LOAD ANYTHING BUT BB BULLETS.

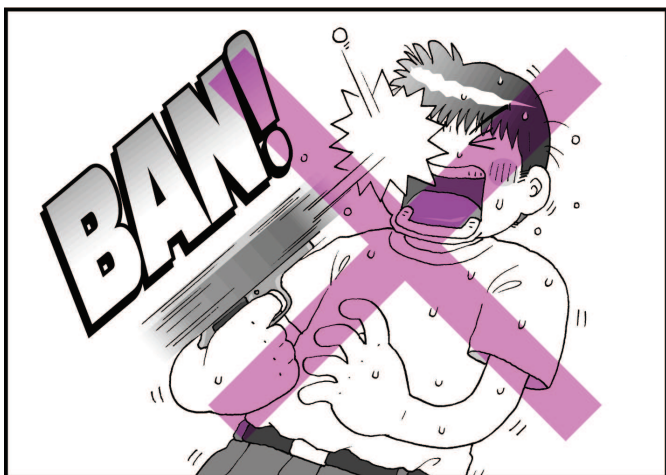

DO NOT LOOK THROUGH THE BARREL



PLEASE SHOOT IN SAFE PLACE

OPERATION

1.REMOVE THE MAGAZINE



PRESS MAGAZINE CATCH AND REMOVE MAGAZINE

2.FILLING GAS

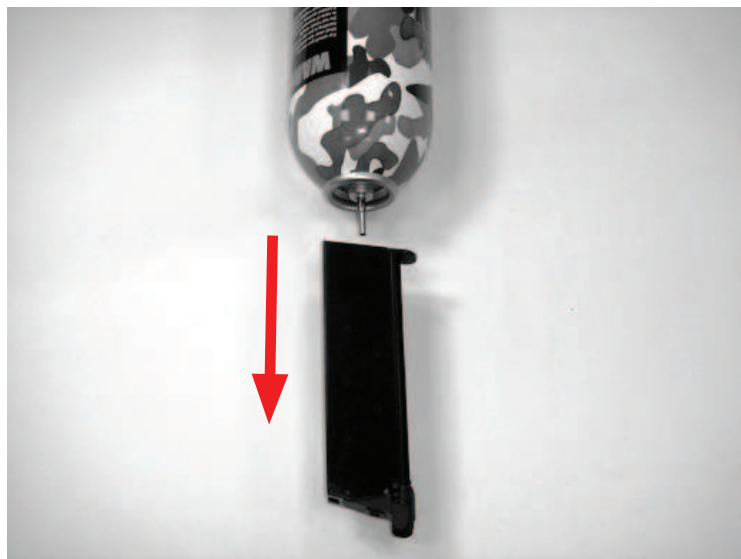

FILL THE GAS BOTTLE TO THE MAGAZINE IN VERTICAL DIRECTION.

3.LOAD BB BULLETS



USE WRENCH TO HOLD THE FOLLOWER AND LOAD BULLETS

4.INSERT MAGAZINE



5.LOAD

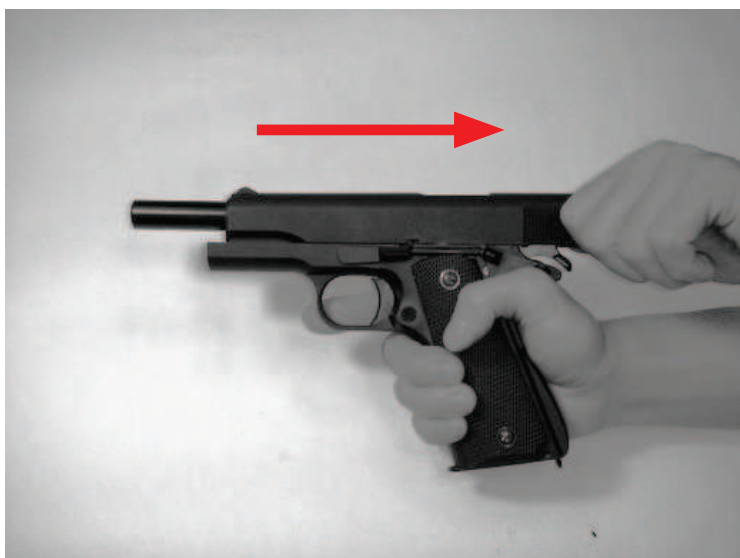

PULL THE SLIDE COMPLETELY TO THE REAR.

6.FIRE



PULL THE TRIGGER.

7.SAFETY

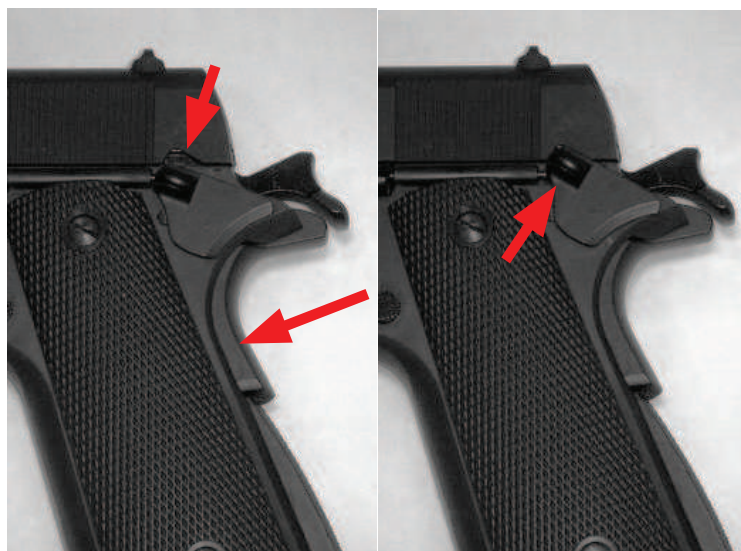

SAFETY OFF(READY FOR FIRE)

SAFETY ON

DISASSEMBLY

1 REMOVE THE SLIDE STOP

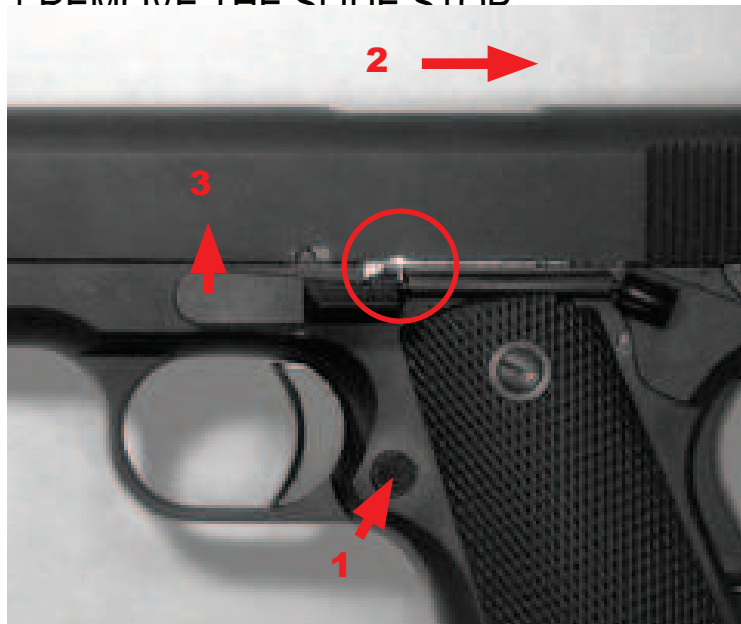

PULL THE SLIDE REAR UNTIL THE TAKEDOWN NOTCH IS JUST ABOVE THE SLIDE STOP TAB AND REMOVE SLIDE STOP

2.REMOVE THE SLIDE



3.REMOVE THE RECOIL SPRING AND SPRING CAP



4.REMOVE THE BARREL BUSH AND BARREL



USE WRENCH TO ROTATE THE BARREL BUSH AND REMOVE IT

5.REMOVE THE BARREL

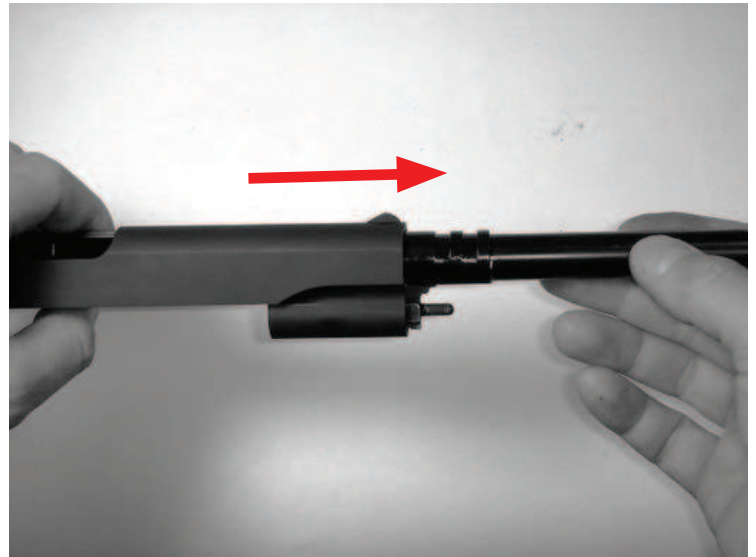

ASSEMBLY

REVERSE THE DISASSEMBLY ORDER

ADJUST TREJECTORY



TWIST THE ADJUST DIAL TO ADJUST TEAJECTORY.

PLEASE ADJUST ACCORDING TO TREJECTORT

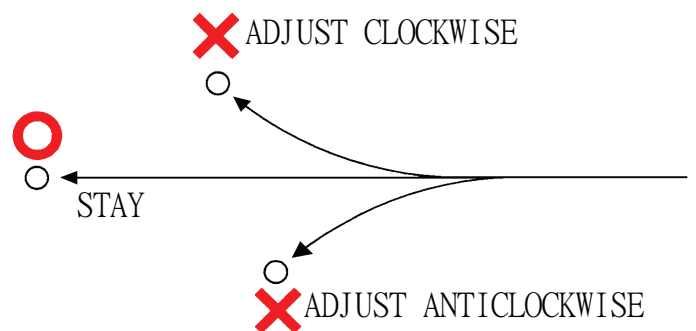

KP-07 EXPLODED DRAWING

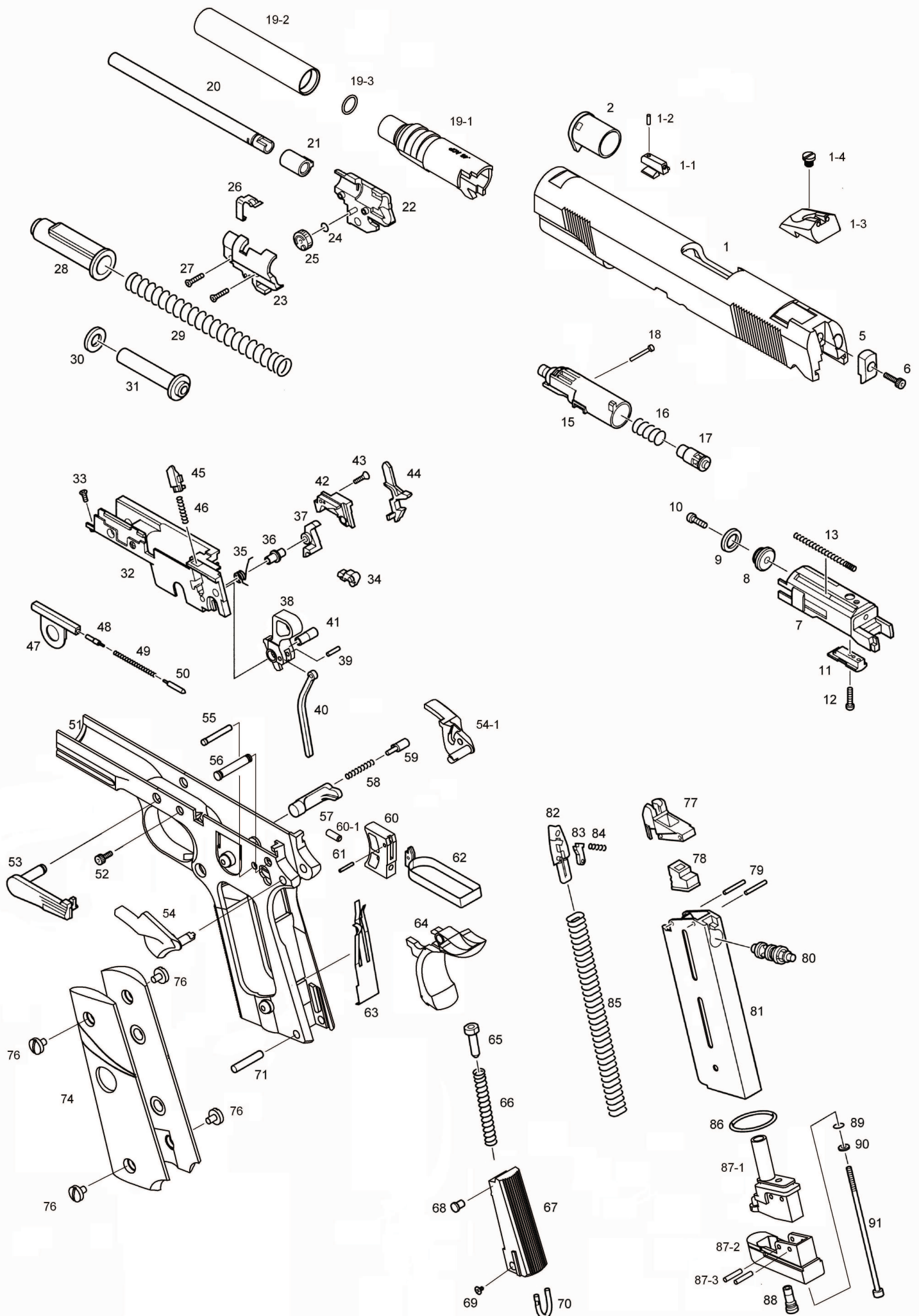

No.	Name of Part	Price	No.	Name of Part	Price
1	Slide	1600	46	Knocker Lock Spring	20
1-1	Front Sight	120	47	Plunger Guide	120
1-2	Front Sight Screw	10	48	Slide Stop Plunger	50
1-3	Rear Sight	150	49	Plunger Spring	15
1-4	Rear Sight Screw	20	50	Safety Plunger	50
5	Firing Pin Stop	100	51	Frame	2200
6	Firing Pin Stop Screw	20	52	Frame Screw	10
7	Cylinder	400	53	Slide Stop	200
8	Ring Head	40	54	Safety	140
9	Ring	20	54-1	Safety(Right)	140
10	Ring Head Screw	10	55	Sear Pin	40
11	Piston Part	30	56	Hammer Pin	40
12	Piston Part Screw	10	57	Magazine Catch	120
13	Cylinder Return Spring	20	58	Magazine Catch Spring	10
14	Cylinder Screw	10	59	Magazine Catch Lock	30
15	Cylinder	150	60	Trigger	120
16	Cylinder Valve Spring	20	60-1	Trigger Screw	20
17	Cylinder Valve	20	61	Trigger Pin	10
18	Cylinder Valve Stopper	20	62	Trigger Bar	120
19-1	Outter Chamber	300	63	Sear Spring	100
19-2	Outter Barrel	300	64	Grip Safety	240
19-3	Outter Barrel O-Ring	10	65	Hammer Spring Plunger	30
20	Inner Barrel	180	66	Hammer Spring	70
21	Rubber Chamber	80	67	Hammer Spring Housing	240
22	Chamber Cover (Right)	140	68	Plunger Stopper	40
23	Chamber Cover (Left)	140	69	Lanyard Loop Screw	10
24	O-Ring	10	70	Lanyard Loop	50
25	Adjust Dial	20	71	Housing Pin	50
26	Adjust Lever	50	74	Grip	400
27	Chamber Cover Screw	10	76	Grip Screw	30
28	Recoil Plug	200	77	BB Lip	60
29	Recoil Spring	60	78	Magazine Gasket	80
30	Recoil Spring Pad	20	79	BB Lip Pin	10
31	Recoil Spring Guide	150	80	Valve	150
32	Front Chasis	300	81	Magazine Case	400
33	Front Chasis Screw	10	82	Follower	30
34	Knocker	40	83	Follower Lever	20
35	Knocker Spring	30	84	Follower Lever Spring	15
36	Sear Sleeve	40	85	Follower Spring	50
37	Sear	60	86	O-Ring	20
38	Hammer	150	87-1	Magazine Bottom-1	180
39	Hammer Strut Pin	10	87-2	Magazine Bottom-2	80
40	Hammer Strut	50	87-3	Magazine Bottom Pin	20
41	Hammer Sleeve	50	88	Filling Valve	70
42	Chassis Cover	80	89	O-Ring	10
43	Chassis Cover Screw	10	90	Washer	10
44	Disconnecter	80	91	Magazine Base Screw	20
45	Knocker Lock	50			

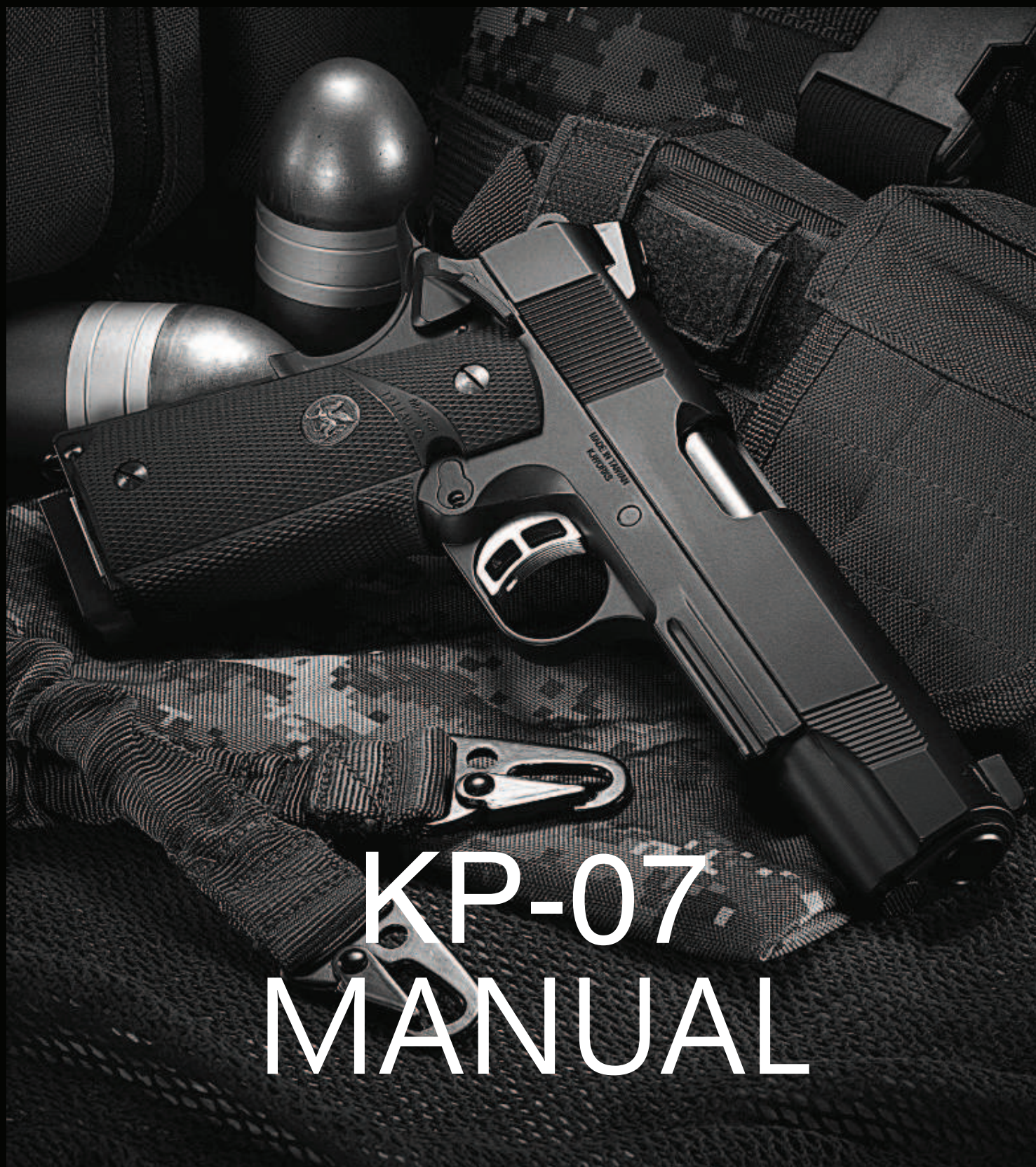

KP-07 MANUAL

KJWORKS